

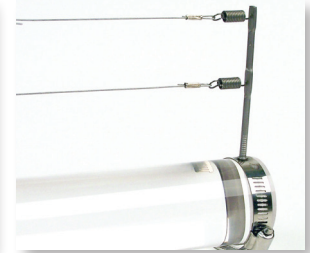

What is FliteLine®?

A discreet post and wire bird deterrent installed on all types of surfaces to deter pigeons and seagulls from landing and roosting. It is not for smaller or larger bird species and should not be used for applications where there are groups or flocks of birds present.

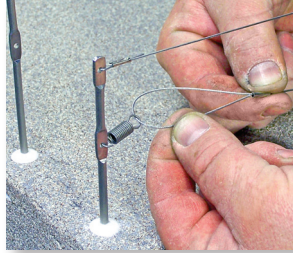

WHEN to use FliteLine

When **Pigeons** and **Seagulls** are the target birds and there are just a few birds present. Do not use FliteLine to deter smaller bird or larger birds. Do not use where birds tend to gather in large groups or flocks.

WHERE to use FliteLine

Install to deter pigeons and seagulls on ledges, window sills, lights, AC units and steel beams. Install where occasional human contact is expected such as hand rails, patios, decks, docks and the top of fences.

FliteLine Materials

FliteLine posts, cables and springs are stainless steel and the remaining items are made from weather resistant materials. See the FliteLine Component list below. Contact Nixalite with any questions about FliteLine.

The FliteLine® Components

Choose the FliteLine components that best suit your application. When ordering, use the Item #'s and descriptions below.

Flite Posts & Hardware

Item #	Description / Min Qty
1. FLP2H4.5NP	Flite Post, SS, 2 hole, 4.5" w/nail point
2. FLP2H6NP	Flite Post, SS, 2 hole, 6" w/nail point
3. FLP2H3.5B	Flite Post, SS, 2 hole, 3.5" w/base
4. FLP2H5B	Flite Post, SS, 2 hole, 5" w/base
5. FLRC01	Flite Post, 1 hole, 1" dia. SS rail clamp
6. FLRC02	Flite Post, 1 hole, 2" dia. SS rail clamp
7. FLRC03	Flite Post, 1 hole, 3" dia. SS rail clamp
8. FLRC04	2 Posts, 1 hole, 4" dia. SS rail clamp
9. FLRC06	2 Posts, 1 hole, 6" dia. SS rail clamp
10. FLFC	Flite Post, SS, 1 hole, 4" w/flange clip
11. FLCM	Flite Post, SS, 2 hole, 4" w/C-clamp
12. FL Cable 100	100' roll, 1/32" SS poly-coat cable, Ea.
13. FL Cable 300	300' roll, 1/32" SS poly-coat cable, Ea.
14. FL Cable 600	600' roll, 1/32" SS poly-coat cable, Ea.
15. FL Crimp Tool	Crimping tool for FL Ferrules, Ea.
16. MHS	Screws for posts w/base or FLPB, 75 ct.
17. FL Spring	Standard SS spring 1/4" x 1/2", 25 ct.
18. FL Spring L	Large SS spring 5/16" x 1-3/8", 25 ct.
19. FL ANCH	Masonry Anchors, 100 ct.
20. FLPB	Plastic Base for Nail Point Posts, 10 ct.
21. FL Ferrules	1/32" nickel plated sleeves, 100 ct.



For more information go to www.nixalite.com/Products/FliteLine-Post-and-Wire-Bird-Deterrent

Estimating and Spacing Your FliteLine® Posts

1. Measuring for FliteLine

Measure and record the **Length** and **Depth** for each installation surface. Split up complex surfaces into smaller, simpler shapes and record the Length and Depth for each.

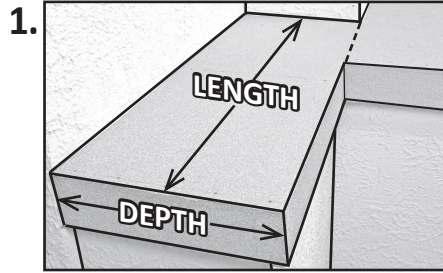

2. Use the FLITE TABLE

Find the **Surface Depth** range that includes your installation surface depth then find the **Rows Required**. This is the number of rows needed for proper coverage on that surface. Repeat for each surface, recording the number of rows required for each surface.

FLITE TABLE		
Surface Depth inches / centimeters		Rows Required
0" - 2"	0 - 5.1cm	1 row
2" - 5"	5.1 - 12.7cm	2 rows
5" - 8"	12.7 - 20.3cm	3 rows
8" - 11"	20.3 - 27.9cm	4 rows
11" - 14"	27.9 - 35.6cm	5 rows
14" - 17"	35.6 - 43.2cm	6 rows
17" - 20"	43.2 - 50.8cm	7 rows
20" - 23"	50.8 - 58.4cm	8 rows
23" - 26"	58.4 - 66.1cm	9 rows
26" - 29"	66.1 - 73.7cm	10 rows

Table shows the number of FliteLine Rows required by surface depth.

3. Spacing Between FliteLine Rows

Space rows **1" (2.5cm) max** from outer edges and **3" (7.6cm) max** between rows. Alternate post heights for multiple row installations.

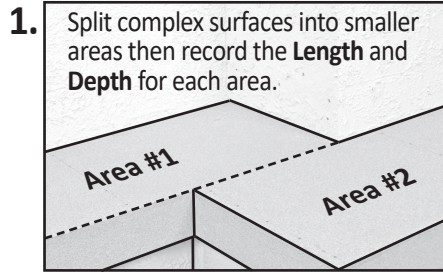

4. Post-to-Post Spacing

In rows 1-5 ft (0.3-1.5m) long use an **Anchor Post** at each end. In rows 5-10 ft long (1.5-3.0m) use Anchor posts at both ends and a **Guide Post** in the middle.

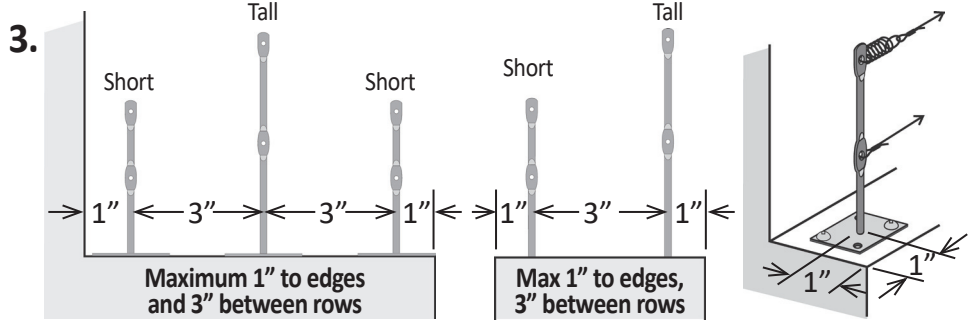

5. What's in each Run of Cable

Use 1 spring (#FL Spring) and 2 ferrules (#FL Ferrules) for each run of cable. When installing multiple runs, use a **Shared Anchor Post** every 10ft (3.0m) max to stop and start cable runs.

Alternate post heights for multi-row installs. Short posts at outside edge with upper & lower cables installed. Single row installations use short posts with both upper and lower cables installed.

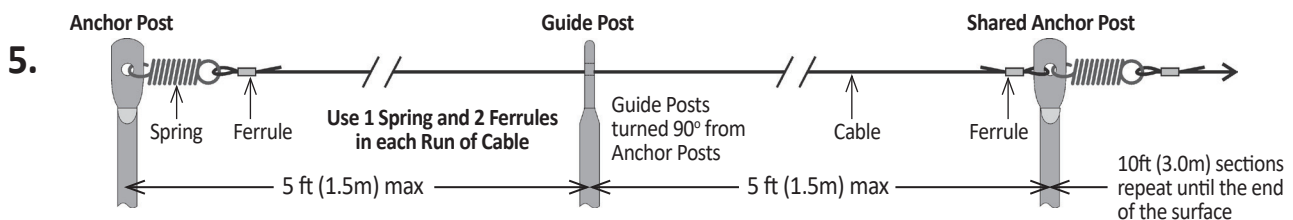
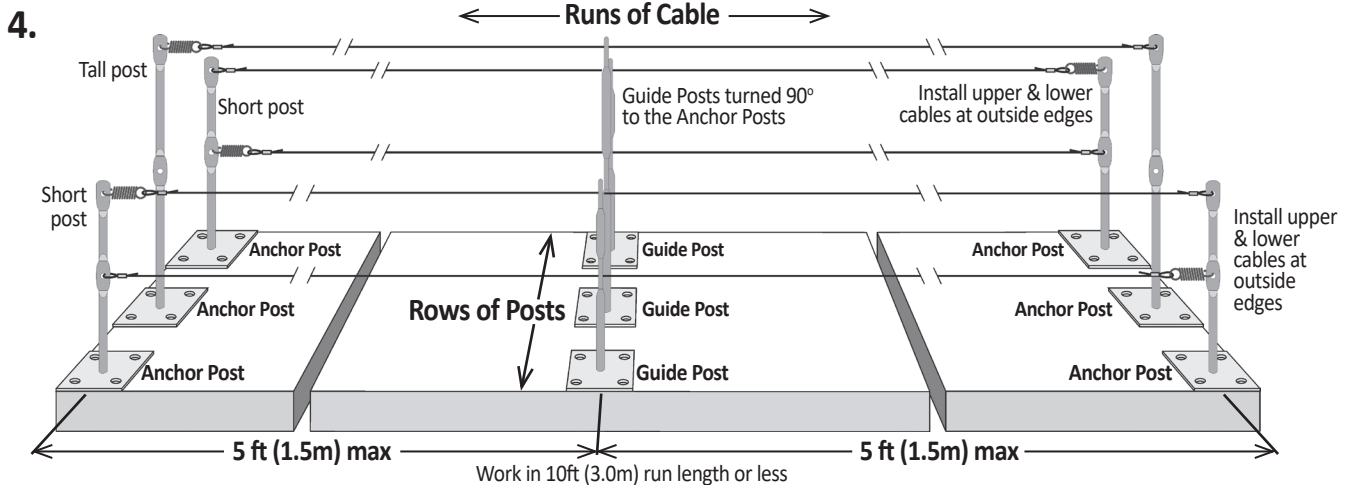

BEFORE You Start Installing FliteLine®



Clean, Sanitize, Deodorize

Never install bird control on surfaces contaminated with bird droppings! It can be hazardous to your health! Wear the proper PPE and always clean, sanitize and deodorize all installation and surrounding surfaces.

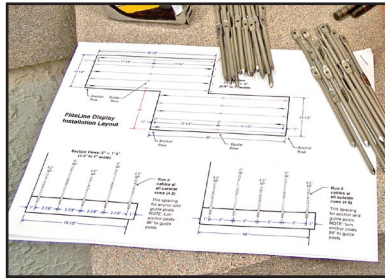

Make A Reference Drawing

Make a simple sketch that shows the layout of the posts, cables, springs, ferrules and fastening hardware. Show the basic post to post and row to row spacing so you know where everything goes before you start.



Confirm You Have Everything

Pull together all of the FliteLine parts, tools and accessories. Identify each part, what it does and where it goes. Count everything and confirm that you have enough to finish the installation before you start.

Installing the FliteLine® Posts

There are different types of FliteLine posts for different types of surfaces. Regardless of application, **ALL FliteLine posts use the same post to post spacing as shown on page 2.** The information below describes the different types of posts, their application and how they are fastened to the installation surface. Contact Nixalite of America Inc with any questions.

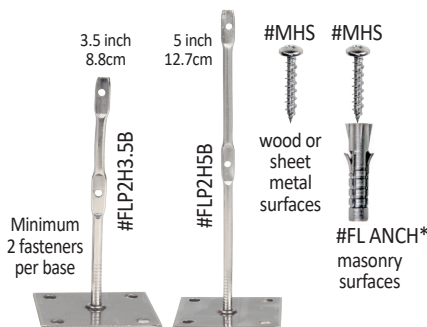

Posts w/Stainless Steel Bases

For flat surfaces. For wood or sheet metal, use screws (#MHS). For masonry, use screws and anchors (#FL ANCH). Use at least 2 fasteners per post base (opposite corners).

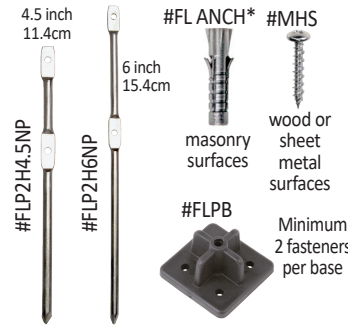

Nail Point Posts & Plastic Bases

For flat surfaces. For wood, drive into a pilot hole 1" (2.5cm) deep. For masonry, use the Anchor (#FL ANCH). Use with the Plastic Base (#FLPB) on flat surfaces (2 fasteners/base).

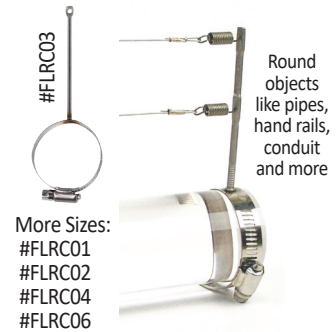

Posts w/Rail Clamps

For suspended objects like pipes and hand rails. Available for objects 1- 6 inch (2.5 to 15.2cm) in diameter. Open clamp, place over object, align the post and tighten the clamp.

***Hole size for Anchor (#FL ANCH) is 1/4" (6.3mm) diameter hole, 1-1/8" (28.5mm) deep**

Post with Hammer-on Clamp

#FLFC for steel flanges and edges up to 1/4" thick. Hammer onto steel only.

Post with Edge/Gutter Clamp

#FLCM for vertical edges or gutters. Clamp opens to a max of 3/4" (1.9cm).

Post with Edge/Flange Clamp

#FLGC for horizontal edges or flanges. Clamp opens to a max of 3/4" (1.9cm).



Vertical surfaces can be used at the end of a FliteLine row. Contact Nixalite for details.

IMPORTANT - if you are not sure what to do or how to proceed, contact Nixalite of America Inc and talk it through with a Nixalite product specialist. We can walk you through most installation procedures or item questions.

Attaching Cable to the Installed Posts

Regardless of the post type, each run of FliteLine Cable is fastened to the installed posts with a Fixed Loop Connection at one end and a Spring Loop Connection at the other end. The fixed connection anchors one end of the cable and the spring connection keeps the cable tensioned. The basic steps for both connection types are shown below.

Fixed Loop Connections

You need one ferrule, the cable and one installed FliteLine post.

1. To make a loop, pass the cable through the ferrule, the eyelet of the post and back through the ferrule.
2. To tighten the loop, push the ferrule towards the post while pulling on the tag end of the cable.
3. Use the FliteLine Crimp Tool to crimp the ferrule. Pull on the cable to make sure the crimp is tight and does not slip. Trim the tag end of the cable.

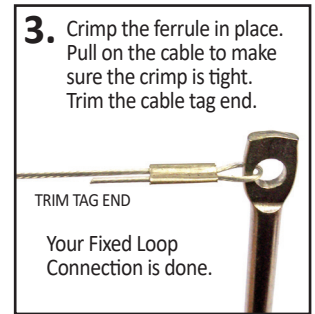
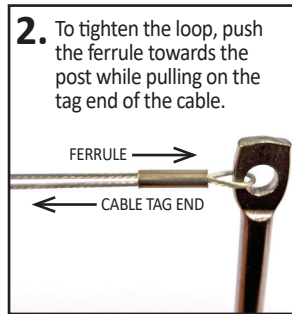
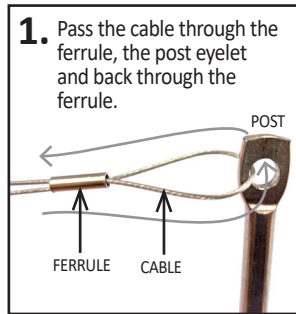

Spring Loop Connections

You need one spring, one ferrule, the cable and one installed FliteLine post.

4. FliteLine springs have eyelets at both ends; one open, one closed. Install the open eyelet through the post eyelet.
5. To make a loop, pass the cable through the ferrule, the closed spring eyelet and back through the ferrule.
6. To tension the cable, push the ferrule towards the spring while pulling on the tag end of the cable. Tighten the cable until the spring just starts to expand. **DO NOT** fully extend the spring.
7. Once you have the proper cable tension, crimp the ferrule in place. Trim the tag end of the cable.

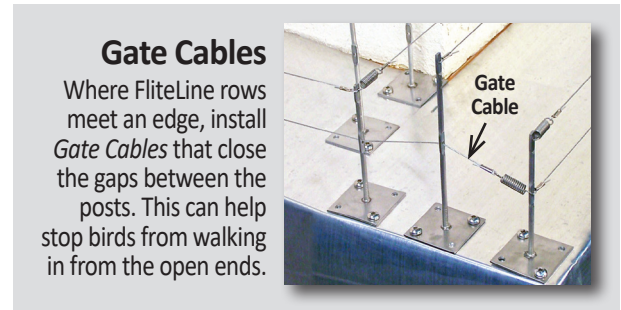
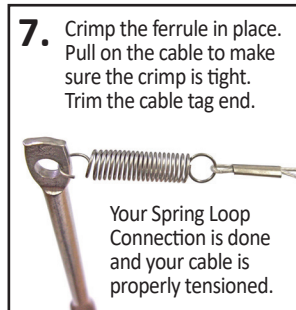
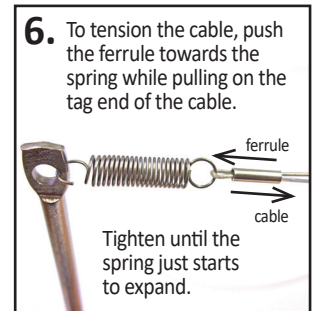
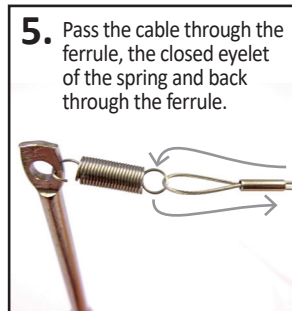
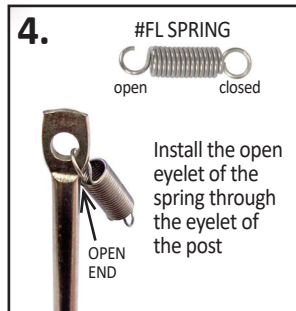

Understanding Post & Wire Limitations

FliteLine is a flexible and discreet bird deterrent used for a variety of applications. While it is versatile, there are limits to what it can do. It is important that you understand these limitations before installing a post and wire deterrent. FliteLine deters pigeons and seagulls where these birds are few in number. It is not for smaller birds, it is not for larger birds and it is not for use where birds gather in flocks. For proven bird control for all types of birds in all levels of infestation, contact Nixalite.



IMPORTANT - if you are not sure what to do or how to proceed, contact Nixalite of America Inc and talk it through with a Nixalite product specialist. We can walk you through most installation procedures or item questions.



Nixalite® of America Inc
 1025 16th Avenue, East Moline, IL 61244
 Experts In Architectural Bird Control Since 1950

P: 309.755.8771 F: 309.755.0077
 E: birdcontrol@nixalite.com
 E: planning@nixalite.com
www.nixalite.com